

Think opportunity. We did.



An innovative solution that reduces homeowner energy costs.

RESCUE EcoTech™ Motor



In home after home, the new Emerson® RESCUE EcoTech™ motor gives you, the contractor, a way to boost indoor direct-drive blower performance levels and efficiencies.

- Designed in the Rescue motor tradition to save you time and money
- Installation as simple as a conventional PSC blower motor
- Exclusive motor control technology provides energy savings and improved comfort.

RESCUE EcoTech is more than just a motor; it's an opportunity.

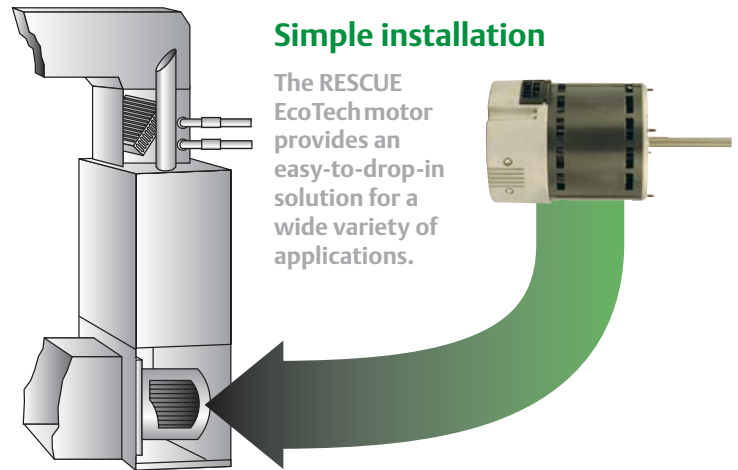

Give homeowners what they want.

Energy efficiency: It's on every homeowner's mind.

In fact, based on a recent study of home purchasing decision criteria, over 70 percent* of homeowners say that energy-efficiency features influence their buying decisions; and with energy costs rising, homeowners are looking for more energy-efficient products to help lower utility bills. That's why our new high-efficiency blower motor is a great opportunity for you – and a smart, energy-saving solution for your customers who can see significant savings on their electricity bill, simply by upgrading their existing system. Not a bad conversation starter.

Average Savings** – Continuous Fan Operation		
	1HP	1/2HP
Five-year savings	\$1,692	\$876
Ten-year savings	\$3,384	\$1,752

Comfort and air quality: What every homeowner expects.

With the increased efficiency of this motor, homeowners will be free to cycle air continuously, without a significant increase in electricity cost. Continuous fan operation helps improve filtration and helps reduce temperature variations throughout the home, helping to clear the air of dust and allergens – all the while making your customers' homes more comfortable.

The RESCUE EcoTech motor's advanced design also features active airflow management, which allows the motor to compensate for static pressure changes to help maintain airflow. This means that as vents are closed or the filter becomes full, the motor will attempt to maintain the same airflow, helping to keep the system operation efficient and the home comfortable.

*National Association of Home Builders

**Savings estimated when compared to PSC operated continuously, electricity cost of \$0.11/kWh

A smart new way to grow your business.

Easy installation – Make no complex changes to your customer's system. No kidding. Emerson's exclusive speed-control technology makes this motor as easy to install as all our RESCUE® line. Drop into existing PSC induction-blower applications, without making complex wiring modifications or changes to the system controls. Just connect the leads, and you're done. No 24-volt signal leads or setup required. It's plug and play.

Fits a wide variety of applications – Since it's a RESCUE motor, you know that it will cover multiple system types and mounting methods, including flex mounts,** opening more opportunities for you, while saving time at installation and investment in inventory.

Easy reversing connector – A simple flip of a connector changes the rotation direction, providing greater flexibility with installation and reducing the number of models that you must have available.

Exclusive motor-control technology – Our exclusive speed-sensing technology allows the RESCUE EcoTech™ motor to connect just like a PSC, while providing the ability to electronically control the motor's output – giving you the correct speed for the application and giving homeowners the efficiency they want.

Ability to upsell – You can show homeowners how to get more out of their current HVAC system. Now you can offer your customers energy savings by just replacing the existing motor in their furnace or air handler.

Excellent complement to existing sales opportunities – Motor trouble isn't the only time you can recommend this new solution to your customers. The RESCUE EcoTech motor's energy story and performance will help you generate additional sales revenue when installing other new equipment, such as indoor air quality products or new air conditioning systems.

Active airflow management – The RESCUE EcoTech motor's advanced electronic control allows the motor to react to changes in the system, maintaining airflow as static pressures change and sustaining system performance as vents are closed or a dirty filter restricts airflow.



Talk to your local Emerson® motor wholesaler today for more information, or visit EmersonClimate.com/RescueEcoTech for more details.

*** 1/2HP rating only, requires accessory kit #44



Remember,
opportunity
doesn't always
knock. Sometimes
it drops right in.
Quickly and easily.

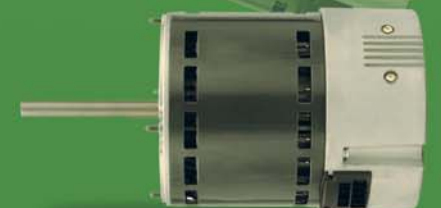

RESCUE EcoTech™ Motor vs. Conventional PSC Motor		
Specification	RESCUE EcoTech	Conventional 5-speed PSC
HP range	1/3, 1/2, 3/4, 1	1/3, 1/2, 3/4, 1
Applications	Air handlers, furnaces, heat pumps	Air handlers, furnaces, heat pumps
Frame	5.6"	5.6"
Voltage	115 or 208–230	115 or 208–230
Maximum efficiency	82%	60-65%
Number of speeds	5	5
Available rpm range	600-1,200 RPM	825-1,140 RPM
Airflow management	Active pressure compensation	None
Installation	Same as PSC , connect speed taps to furnace/air-handler control board	Connect speed taps to furnace/air-handler control board
Number of leads	7 total – 5 speed taps, common and ground	7 total – 5 speed taps, common and ground
Speed selection	Via speed tap	Via speed tap

Features:

- Reversible rotation
- No capacitor required
- Class B insulation
- 40°C ambient rated
- Continuous duty, air over
- 48 frame (5.6" diameter)
- Electronically protected motor
- Ball bearing
- 36" leads
- Belly-band mounting

Specifications						
Cat. #	HP	RPM-High Speed	Speeds	Volts	Shaft dim.	Overall length
5520ET	1/3	1140	5	115	1/2 x 4"	9.75"
5521ET	1/3	1140	5	208–230	1/2 x 4"	9.75"
5530ET	1/2	1140	5	115	1/2 x 4"	9.75"
5531ET	1/2	1140	5	208–230	1/2 x 4"	9.75"
5540ET	3/4	1140	5	115	1/2 x 4"	10.75"
5541ET	3/4	1140	5	208–230	1/2 x 4"	10.75"
5550ET	1	1140	5	115	1/2 x 4"	11.25"
5551ET	1	1140	5	208–230	1/2 x 4"	11.25"

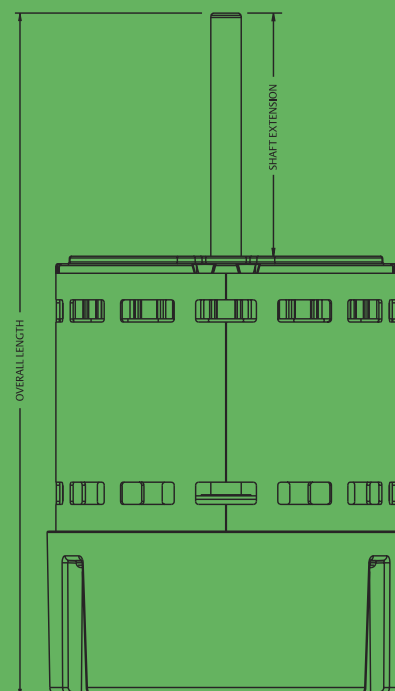

EcoTech™ Motors– Responsible use of energy through technology.

